

Asset Management Business Line

R. Brett James, LLA, AICP
Asset Management Business Line Leader

9 March 2022

Asset Management Business Line



- One of Five Business Lines Engaged to Deliver on our Customers' Needs
- Serving SW Navy and Marine Corps
- Divided into Three Product Lines
 - Planning
 - Asset Utilization
 - Public-Private Partnerships (housing)
- Execution via In-house and Contract
- Contracts Vehicles: NAVFAC IDIQ's to include Small Business IDIQ

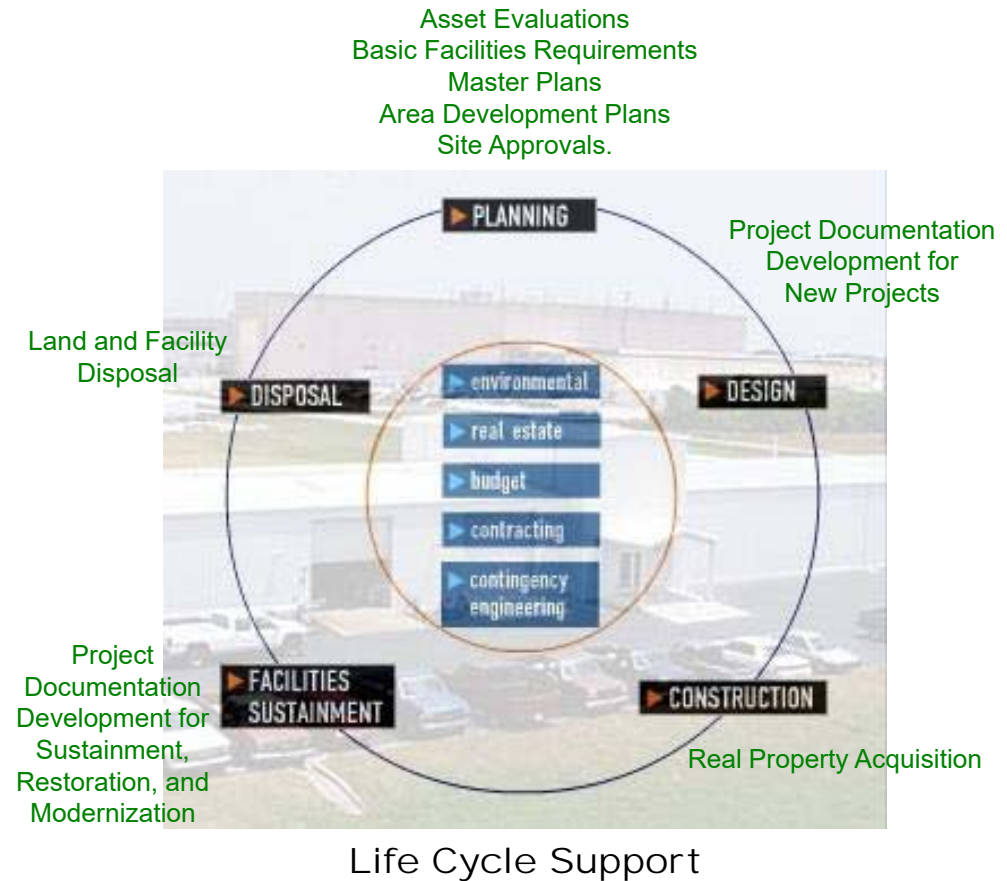

Facilities Planning Product Line



- **Customers:** Navy and Marines Corps throughout SW; various other units
- **Products & Services:**
 - Installation Master Plans, District Plans, Site Studies
 - Special Studies in Support of Specific Missions or Platform Bed-downs
 - Requirements Assessments (land and facilities required to meet unit missions)
 - Inventory (existing land and facilities, their use, condition, suitability)
 - Project Development Documentation (project justification, parametric cost estimates, business case and economic analyses, facility plans)
- **Approach:** In-house and Contract
- **Contracting Info:**
 - Total Dollars Contracted: FY21 ~\$13M
 - Contract Types: Small Business & Traditional IDIQ
 - Contracts: NFSW; NAVFAC PAC and LANT

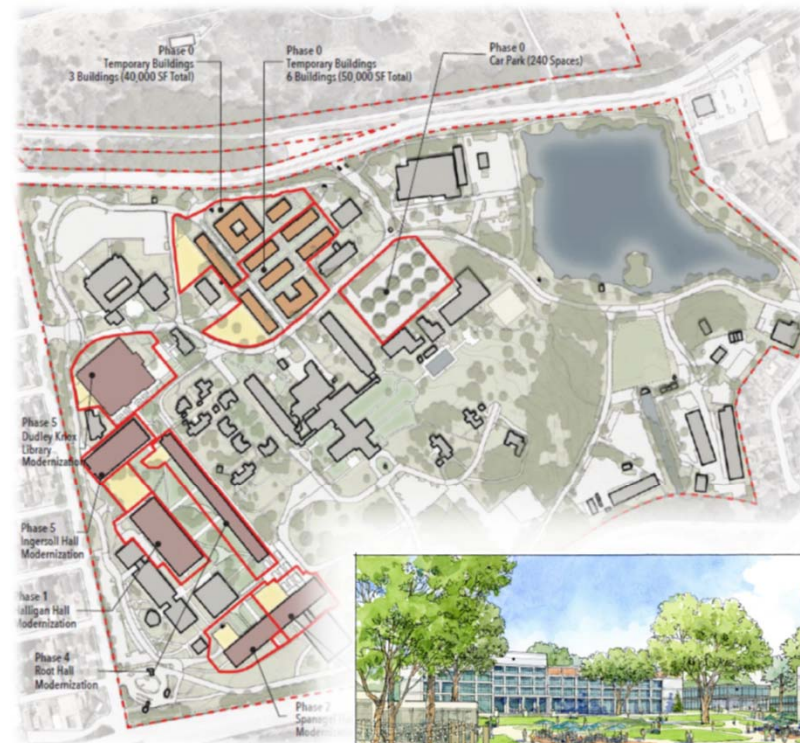

Asset Utilization Product Line



– P&S Provided:

- **Geospatial Data Services:** Integrate and manage diverse geospatial data sets in support of Installation Operational Missions (Air Operations, Port Operations, Planning, Asset Inventory, Emergency Management, Explosive Safety)

– FY19-21 Contract Value: ~\$8.5M

- Natural & Cultural Resource Data Collection & Integration
- System/Workflow Design & Modeling within ArcGIS Enterprise
- Utility Data Collection & Condition Assessment Surveys ~ \$800K
- Telecommunication Data Collection & Conversion

– Future Contract Awards:

- Utility Data Collection ~ \$400K - \$1.5M
- Installation Sustainability & Resiliency ~ \$400K - \$600K

– Contracts: NFSW IDIQ, NAVFAC LANT IDIQ

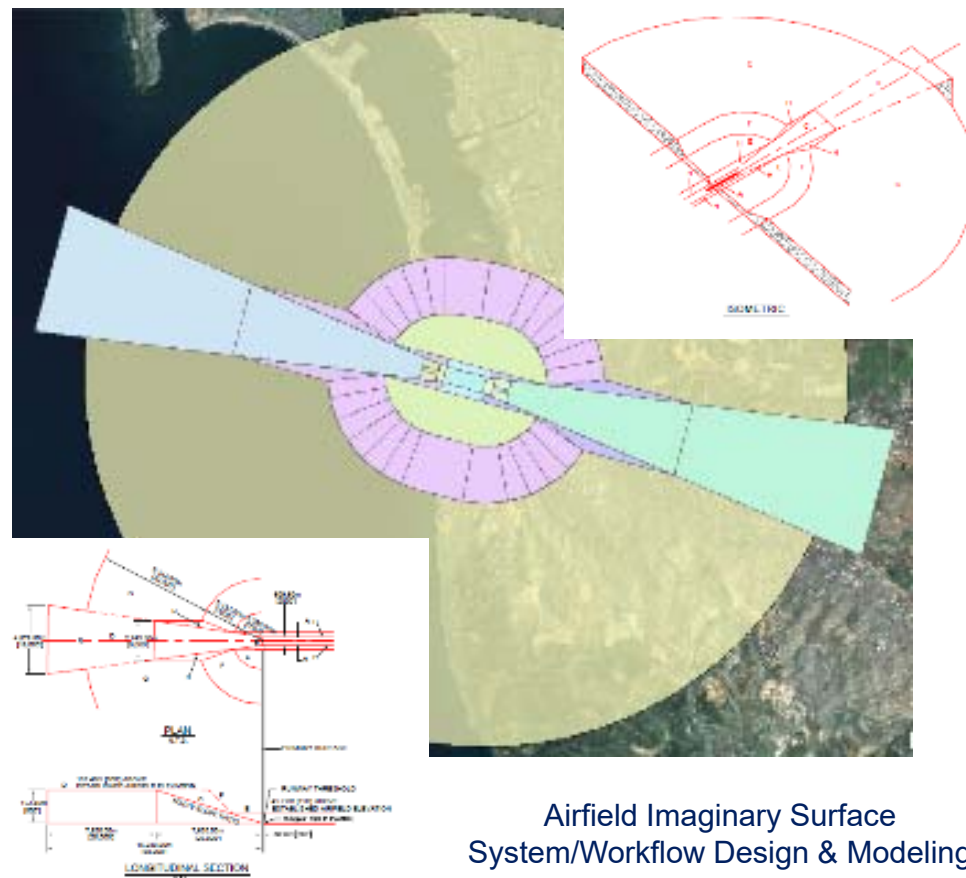

Airfield Imaginary Surface System/Workflow Design & Modeling

Public Private Venture Product Line



- **23,200 Family Housing units across the SW Area of Responsibility**

- 16,500 in Metro San Diego/Camp Pendleton
- Coleville – 110 Lemoore – 1,600
- China Lake – 190 Ventura – 1320
- Fallon – 220 Twenty Nine Palms – 2150
- Seal Beach – 190 El Centro – 100
- Yuma – 820

- **2,400 Unaccompanied Housing units on Naval Base San Diego**

- **Partners manage day-to-day operations/maintenance/sustainment**

- **50 year agreements**



QUESTIONS?

R. Brett James, LLA, AICP
Asset Management Business Line Leader
NAVFAC Southwest
619-705-6300