

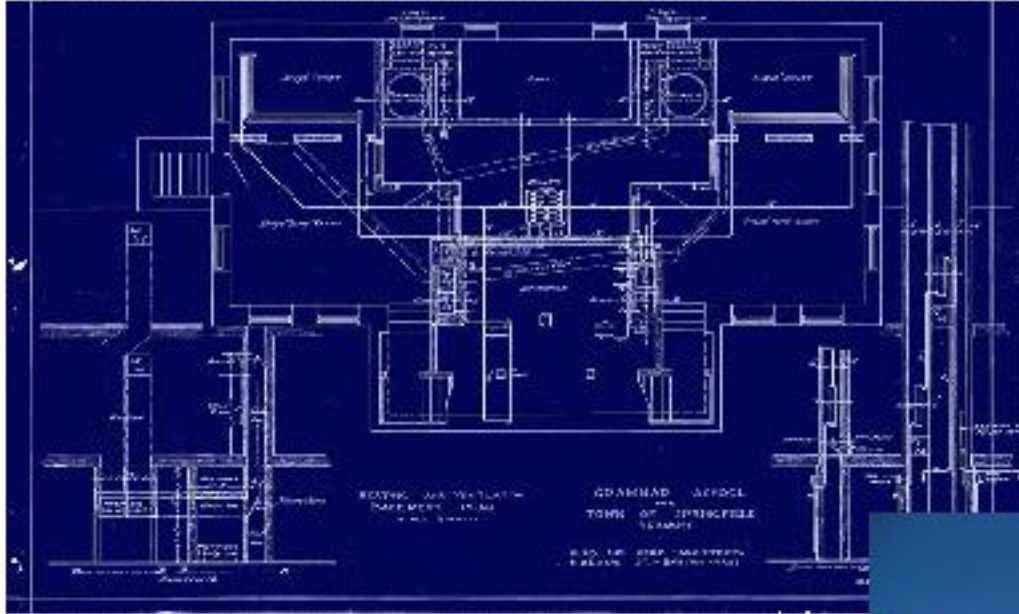

**General Services Administration  
Heartland Region – R6**

# Design & Construction Program



A/E

CM

Specialty Consulting

- Sustainability
- Facilities
- HPW

- Annual Minor Program
- Capital Program
- Consulting Opportunities  
See above right



# GSA Public Buildings Service

**Mission:** To provide superior workplaces for federal customer agencies at good economies to the American taxpayer.

## **Key Functions**

- Design & Construction
- Leasing
- Facilities Management
- Disposal
- Historic Preservation

**Owned Buildings Nationwide:** 1,500

**Rentable square feet:** 370.2 Million Square Feet

# Range of Opportunities

Green Proving Ground      Subcontractors

Art in Architecture

**Facilities Management**      ESPC

Appraisal Services      BIM      Prime Contractors

**A/E Services**      **Repair & Alterations**

Smart Buildings

Building Automation Systems

**Construction**

CQM      Smart Buildings

**Operations & Maintenance**

**Leasing**      Historic Preservation

# FY14 Heartland Small vs. Large Business

Large Business  
38%

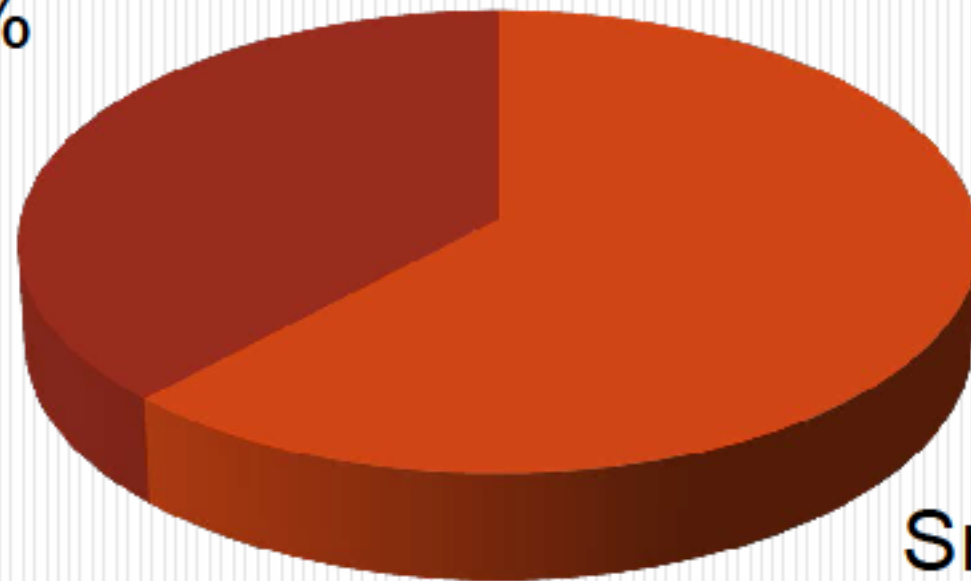

Small Business  
62%

\$52.9 Million Total

# R6 Small Business Goals

<b>SB Category</b>	<b>Actual Dollars</b>	<b>Goal %</b>	<b>Actual %</b>
Small Business	\$32.79 Million	50%	62.03%
Small Disadvantaged	\$16.1 Million	7%	30.47%
Woman Owned	\$5.4 Million	5%	10.27%
Service Disabled Veteran	\$4.5 Million	4%	8.44%
Certified HUBZone	\$2.8 Million	3%	5.29%

\* FY14 Data

# R6 Prospectus Projects

## **Repair and Alterations Project**

Prevedel Federal Building

Overland, MO

Procurement method - IDIQ Design-Build

## **Seismic Project**

Robert A. Young Federal Building

St. Louis, MO

Procurement method - Design-Build, Full and Open

## **Electric Vaults and Tunnel Project**

Federal Complex, 4300 Goodfellow

St. Louis, MO

Procurement method - IDIQ Design-Build

## **Infrastructure Project**

Federal Building, 2306/2312 Bannister

Kansas City, MO

Procurement method - IDIQ Design-Build

## PBS Region 6 Expiring IDIQ Contracts

<b>Geographic Area</b>	<b>Contract Type</b>	<b>Contract Expiration</b>
St. Louis	A/E	May 2015
Nebraska	A/E	June 2015
KC Metro & KS	A/E	Dec 2015
KS, MO, NE, IA	Design-Build	Oct 2015
KS, MO, NE, IA	Construction	Dec 2016
KS, MO, NE, IA	Under \$150k IDIQ Contract	Construction March 2015



<http://www.gsa.gov/portal/content/101163>

**John Topi, P.E.**

Director of Design and Construction  
General Services Administration  
Heartland Region  
2300 Main Street, 7th Flr, SW  
Kansas City, MO 64108  
(816) 823-4903 - Office  
(816) 806-4297 - Mobile  
E-mail: john.topi@gsa.gov



**Zachary Hawks**

Project Management Branch Chief  
E-mail: zachary.hawks@gsa.gov

## Best Avenue to Pursue GSA Business

Register with **FedBizOpps** to be notified of federal government business opportunities of interest to you.

**SAM**

**FBO.gov**

**Small Business Forecast:**

<http://www.gsa.gov/smbusforecast>



**General Services Administration  
Heartland Region – R6**